

XL-FF6

LIGHTWEIGHT FORWARD FOLD SLEEPING ROOM FOR SIX

The new Lightweight Forward Fold is Stoney Creek Campers spacious new camper that includes a rear slide out bed and can sleep up to 6 people. This camper is perfect for quick getaways as it is light weight, easy to set up and can be towed by small to medium SUV's and Sedans. The XL-FF6 has all the advantages and comforts of the forward fold concept but with a light tare and tow ball weight.



» FEATURES



SUSPENSION

Independent suspension with shock absorbers, coil springs with 10" heavy-duty electric brake assist setup and handbrake. This lightweight camper will make travelling Australia a complete breeze.



4 SEAT DINETTE

Featuring a modern interior layout with a spacious 4 seat dinette, cushioned seating and a drop table which converts to a third bed area.



KITCHEN

Camp cooking in style with a slide-out kitchen including a SMEV stove with protective glass top, stainless steel sink, 12V pump, tap and storage.



COMFORT

The interior of this lightweight model features a queen sized and double bed, both with a generous, thick mattress. You will enjoy a fantastic night sleep wherever your travels take you.



WATER TANK

The XL-FF6 is equipped with a 100L stainless steel water tank with aluminium tank guard to protect you during your on road adventures.



STORAGE

Never run out of storage space, the XL-FF6 features storage compartments on both sides of the camper with large and small slide-out drawers.

» SPECIFICATIONS

STANDARD

| | |
|----------------|---------|
| Body Length | 3,000mm |
| Overall Length | 4,600mm |
| Travel Height | 1,450mm |
| External Width | 1,800mm |
| Tare Weight | 980kg |
| ATM Weight | 1,350kg |
| Ball Weight | 80kg |

NB: Measurements, weights and fit out inclusions are provided as a guide only and are not binding. With the inclusions of accessories these specifications may vary, it is advisable to discuss with your Stoney Creek representative.



Suitable for 6 people

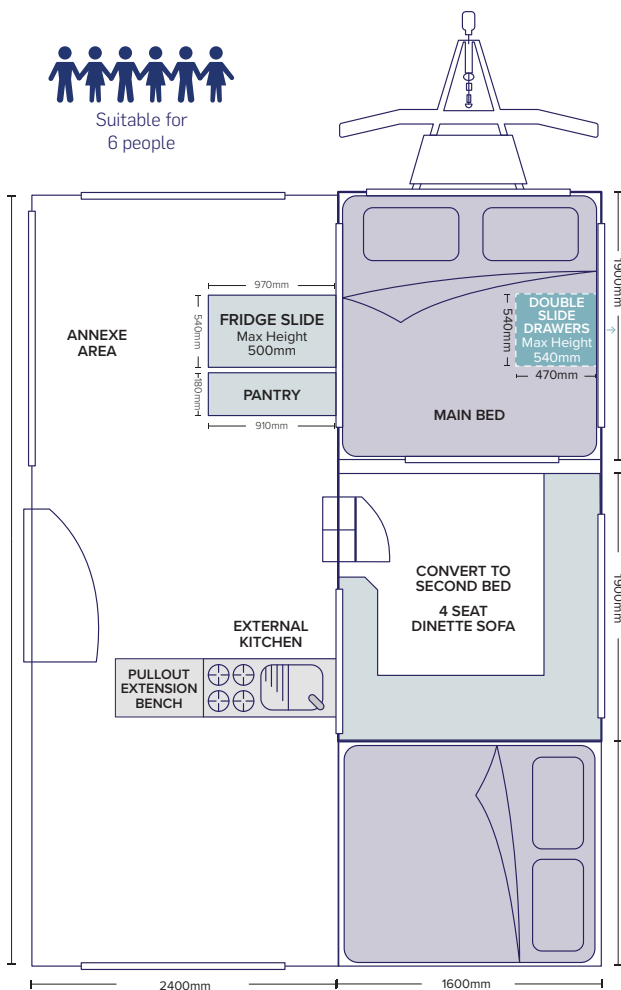

EXTERIOR

| | |
|---------------------------------------------------------------|---|
| Cooktop — SMEV Gas Stove Top | ☑ |
| Chassis — Hot Dipped Galvanised | ☑ |
| Coupling — ADR Approved | ☑ |
| Dropdown Legs — Corner Supports Wind-down | ☑ |
| Gas Bayonet | ☑ |
| Gas Bottle | ☑ |
| Jerry Can Holders — Dual | ☑ |
| Jockey Wheel — 10" Swing-up and Lockable | ☑ |
| Lighting — LED Light | ☑ |
| Mud Flaps | ☑ |
| Battery Charger 12V/240V Management System | ○ |
| Power — 12V Weatherproof Connection | ☑ |
| Solar System — 160w Panel with Regulator | ○ |
| Solar Wiring — via Anderson Plug | ☑ |
| Stone Guard — In-line with Front Toolbox | ☑ |
| Suspension — Independent with Shock Absorbers and Coil Spring | ☑ |
| Tap — Mains Pressure to A-Frame | ○ |
| Tent Section — Heavy-duty 14oz Canvas | ☑ |
| Trailer Plug Connection — Included to Suit Vehicle | ☑ |
| Hot Water System | ○ |
| Ventilation — Tent Window Flyscreens | ☑ |
| Water Pumps — 12V Pump and External Switch | ☑ |
| Water Tank — 100L Stainless Steel | ☑ |
| Wheel — Spare Tyre | ☑ |
| Wheels — 185/100R14 8PR | ☑ |

INTERIOR

| | |
|--------------------------------------------------------------|---|
| Main Bed including Mattress — 1900mm x 1400mm | ☑ |
| Bed Converter to Dining Lounge Bed — Double Bed (second bed) | ☑ |
| Additional Rear Double Bed — 1500mm x 1100mm | ☑ |
| Battery 100amp AGM | ☑ |
| Floor Vinyl — Durable Modern Design | ☑ |
| Lights — 12V LED x 4 | ☑ |

SAFETY

| | |
|--------------------------------------------------------------------|---|
| Brakes — 10" Heavy-duty Electric Brakes Assist Setup and Handbrake | ☑ |
| Cooktop Flame Failure Device | ☑ |
| Fire Extinguisher | ☑ |
| Lights — Side LED Running | ☑ |
| Water Filler — Lockable | ☑ |

APPLIANCES

| | |
|-----------------------------------------------|---|
| Cooktop — SMEV Gas Stove Top | ☑ |
| Fridge — 12V/240 Fridge/Freezer | ○ |
| Stereo — CD/Stereo/DVD with External Speakers | ○ |
| TV Aerial — 12V | ○ |
| TV/DVD — 12V, 19" or 22" HD LCD | ○ |

FEATURES ☑ Standard ○ Optional



CONVENIENT AND COMFY

Even with a ball weight of only 80kg, you've still got plenty of room to fit the whole family.